

Now Available!

VARI-TAP DI Tapping Saddle

**To Australian
and
New Zealand
Standard
AS/NZS 4793**

See reverse for installation guide

PIPE COMPATABILITY FOR SADDLE CONFIGURATIONS

Saddle Configuration	Pipe Material	Pipe Standard
Type F Configuration for Flexible Pipe	PVC-U	AS/NZS 1477
	PVC-M	AS/NZS 4765
	PVC-O	AS/NZS 4441
	MSCL	AS 1579
	GW1	AS 1074
Type R Configuration for Rigid Pipe	DICL	AS/NZS 2280 ISO 2531
	CICL – Class B	AS 1724
	CICL – Class C	AS 2544
	AC – Class AB & CD	AS 1711
	ABS (PN9 or higher)	AS 3518
	GRP (SN 10,000 or higher)	AS 3571

IMPORTANT – PLEASE READ PRIOR TO INSTALLATION

- The nitrile rubber gasket in this product is only recommended for use in temperatures ranging from 0° to 60°C.
- Type R configuration should not be used on pipe with a ring stiffness rating of less than SN 10,000

tyco
Water

Tyco Water – WANG Components
ABN 75 087 415 745
Cnr. Gibson & Sandford Roads
Wangaratta, Victoria 3677, Australia
Phone (61) 03 5722 7400

F20:52R1

WANG VARI-TAP

DI TAPPING SADDLE

INSTALLATION GUIDE

Please read ALL information on both sides of this guide prior to installation.

Recommended Equipment

- Tension Wrench (0-100Nm) & 24mm socket
- Pipe surface cleaning equipment

Initial Preparation Clean the pipe surface, making it as clean and free of soil, mud and scale as possible in order to achieve the best possible seal

Step 1 All Pipe

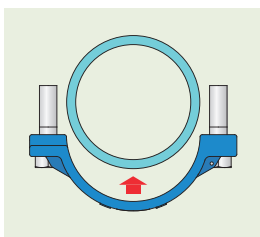

Position bottom band in the desired location on the pipe. Select an area of pipe that is as clean and free of blemish as possible

Step 2.F

Type F

Configuration for Flexible Pipe

- PVC-U
- PVC-M
- PVC-O

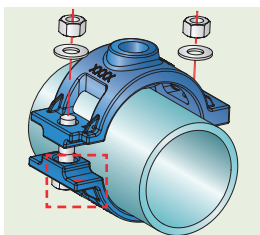

For Flexible pipe, position top band to make 'F' visible in the cut-out corner



OR

Step 2.R

Type R

Configuration for Rigid Pipe

- MSCL/GW1
- DICL
- CICL : class B & C
- AC : class AB & CD
- ABS (\geq PN 9)
- GRP (\geq SN10,000)

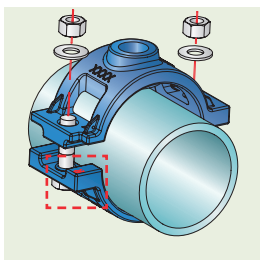

For Rigid pipe, position top band to make 'R' visible in the cut-out corner

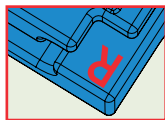

Step 3 All Pipe

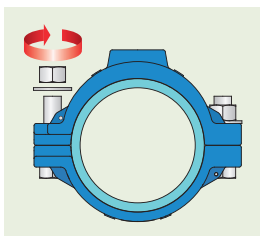

Hand tighten nuts and then tension to 80Nm torque. Avoid rotating the saddle once in contact with the pipe.